

Top Profile

Code

XXXTOP4100

Finish / Material

Aluminium

Dimensions

4100 x 56.5 x 27.2mm

Accessories available

Quick Fix Brackets (100QFIX)

End Cap - Top (XXXTOPENDCAP)

Internal Corner Joint - Top (XXXTOPINT90)

External Corner Joint - Top (XXXTOPEXT90)

Joint Section (XXXTOPJOINT)



- Used for base unit doors and top drawers.
- Can be cut to size using a circular chop saw.
- Secured to cabinets with Quick Fix Brackets.
- Profiles can be finished off with End Caps before fitting.
- Top profiles can be linked at internal and external corners using Corner Joints.
- Straight lengths of top profiles can be linked together using the Joint Section.
- Base cabinets need to be routed, unless using TKC's pre-routed Vero Quickcab.

DIMENSIONS

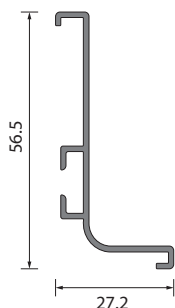

FITTED DETAIL

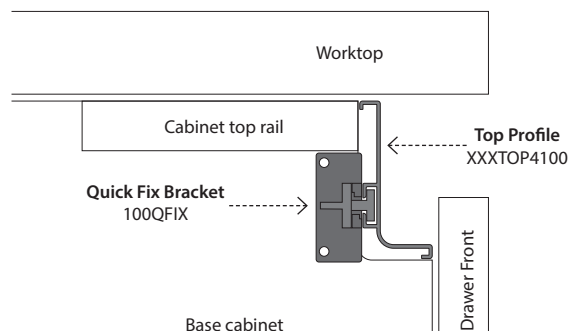

BASE CABINET ROUTING

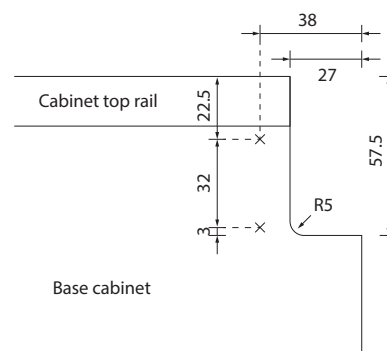

BASE CABINET DIMENSIONS

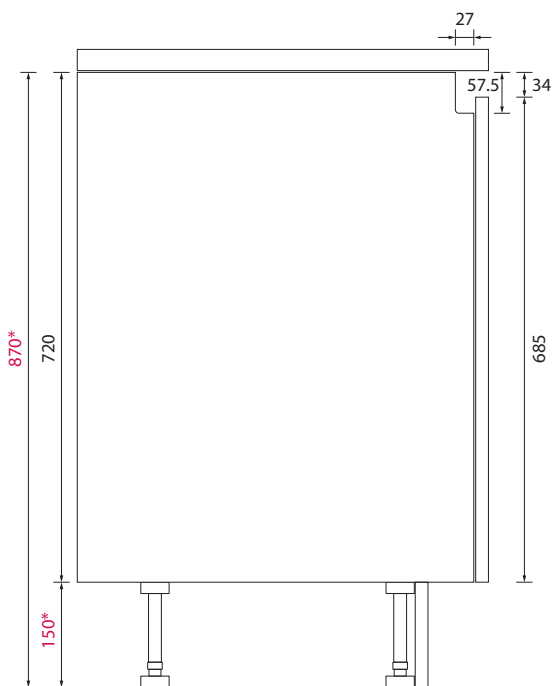

* **nb.** If installing integrated under counter appliances please increase leg height to allow for easy installation of appliance. See p. 10 for more information.

BASE UNIT COMPONENTS

1. Top Profile (XXXTOP4100)
2. Internal Corner Joint - Top (XXXTOPINT90)
3. External Corner Joint - Top (XXXTOPEXT90)
4. Quick Fix Bracket (100QFIX)
5. End Cap - Top (XXXTOPENDCAP)

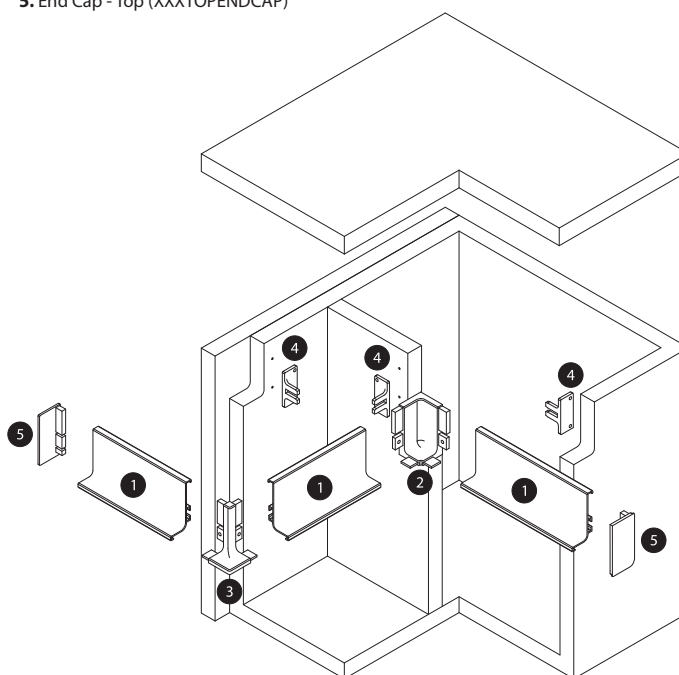

Mid Profile

Code

XXXMID4100

Finish / Material

Aluminium

Dimensions

4100 x 73 x 26mm

Accessories available

Quick Fix Brackets (100QFIX)

End Cap - Mid (XXXMIDENDCAP)

Internal Corner Joint - Mid (XXXMIDINT90)

External Corner Joint - Mid (XXXMIDEXT90)



- Used for mid and bottom drawers.
- Can be cut to size using a circular chop saw.
- Secured to cabinets with Quick Fix Brackets.
- Profiles can be finished off with End Caps before fitting.
- Mid profiles can be linked at internal and external corners using Corner Joints.
- Base cabinets need to be routed, unless using TKC's pre-routed Vero Quickcab.

DIMENSIONS

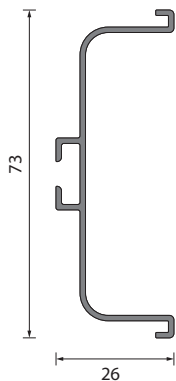

FITTED DETAIL

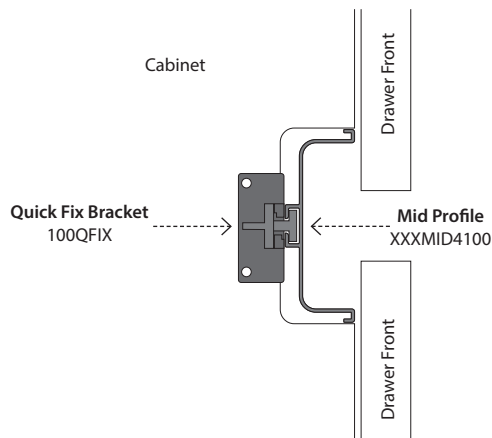

BASE CABINET ROUTING

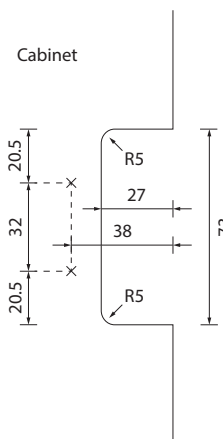

BASE CABINET DIMENSIONS

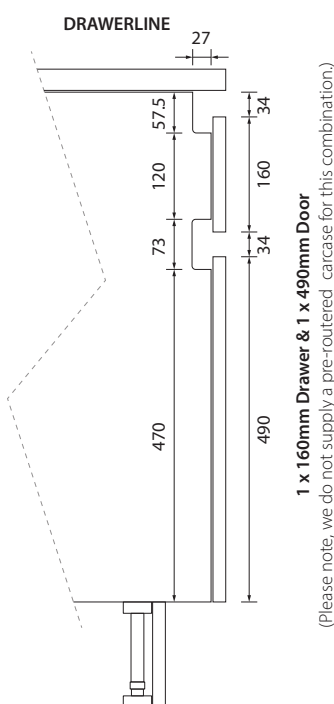
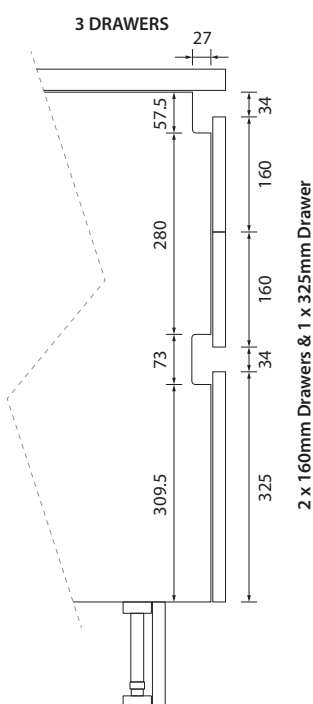
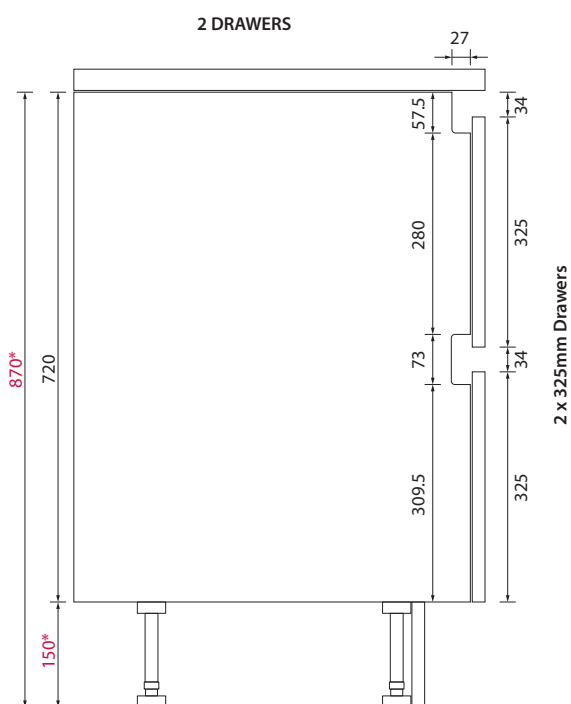

* nb. If installing integrated under counter appliances please increase leg height to allow for easy installation of appliance. See p. 10 for more information.

Installing under counter appliances

Integrated dishwasher

- The Top Profile (XXXTOP4100) can be used to run above an integrated appliance.
- It is recommended to **set integrated dishwasher height at 815mm** and adjust carcase legs to a min. height of 155mm. Please note, these dimensions are based on standard height dishwasher. Cabinet legs may need to be raised further if appliance height is different.
- Metal brackets (supplied with dishwasher) should be fixed to the outer face of adjacent cabinets. Please note, an additional bracing baton may be required to the rear of the machine to help reduce movement.
- If drawers are situated next to an integrated appliance, we recommend using end caps to cover any gaps.

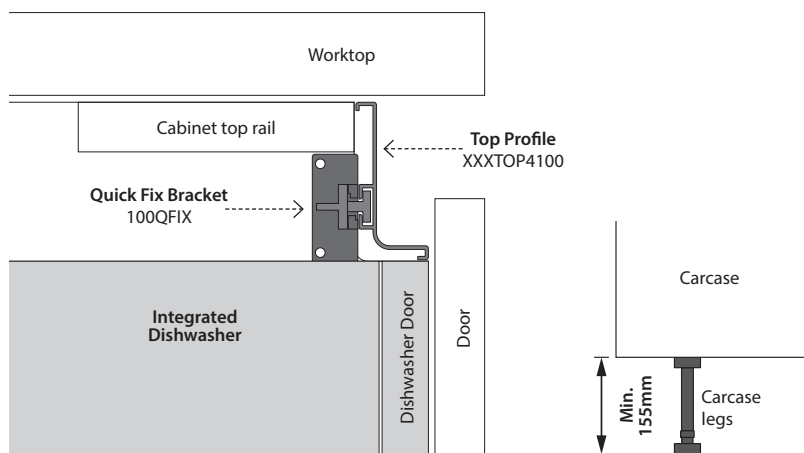

IMPORTANT INFORMATION

We recommend extending the cabinet legs to a minimum height of 155mm to ensure the integrated dishwasher will fit easily.

Always check the minimum height of your under counter appliances before installing your Vero kitchen to ensure there is enough clearance under the top rail.

Integrated dishwasher with Vero handleless rail system

Under mounted oven

- The Top Profile (XXXTOP4100) can't be used in conjunction with an under mounted oven. Profiles must stop on each side of the appliance and can be finished with End Caps.
- If using a freestanding cooker, end panels will need to be fitted on either side of the appliance and the profile needs to be finished against the panel.

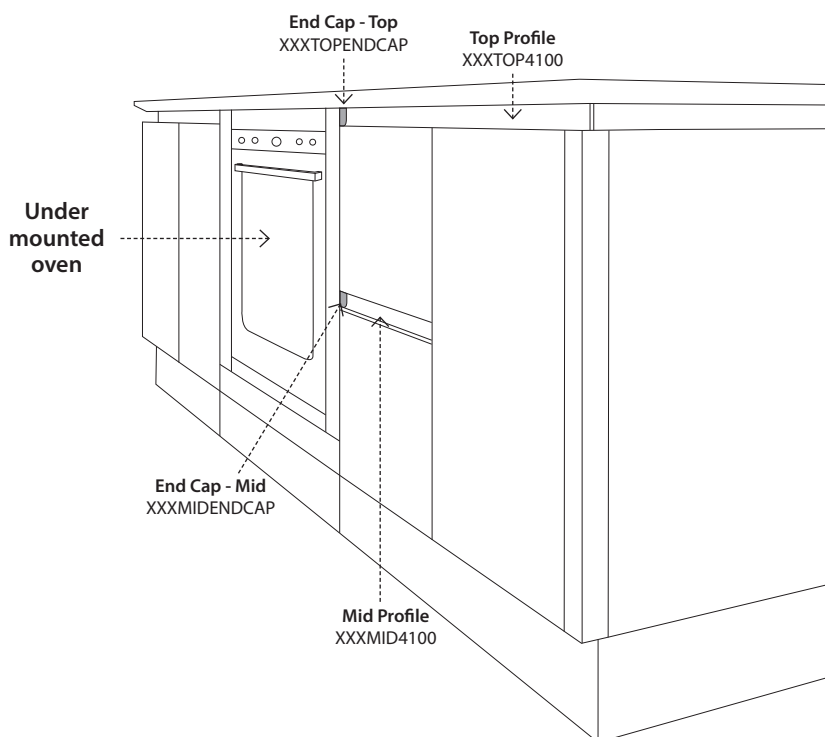

Vertical Profile - Intermediate

<p>Code XXXVERTMID4200</p> <p>Finish / Material Aluminium</p> <p>Dimensions 4200 x 71.6 x 41mm</p> <p>Accessories available XXXVERTSPACER</p>	 <ul style="list-style-type: none"> Used on tall units when two opening doors meet. Secured to cabinet gables with 25mm cabinet screws. Can be cut to size using a circular chop saw. A 35mm spacer (not supplied) is required at the back between the two cabinets to maintain the void created by the profile trim. The front of the cabinet gables need to be set back by 20mm for the trim to overlap behind the doors (unless using TKC's Vero Quickcab).
---	--

DIMENSIONS

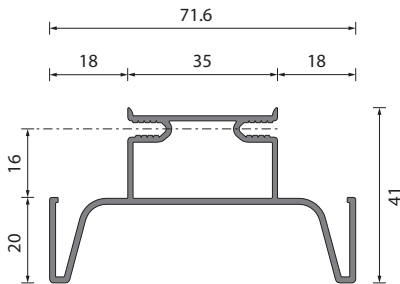

FITTED DETAIL

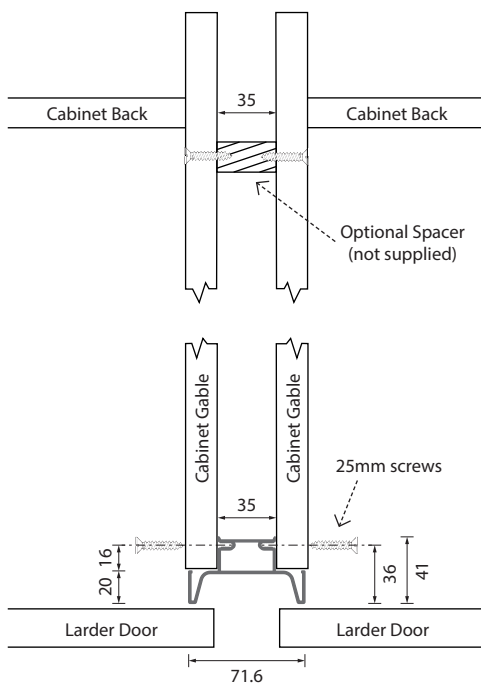

APPLICATION BETWEEN TWO DOORS

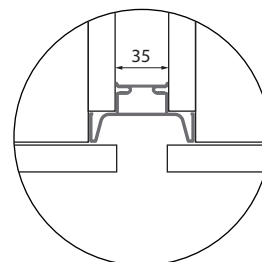
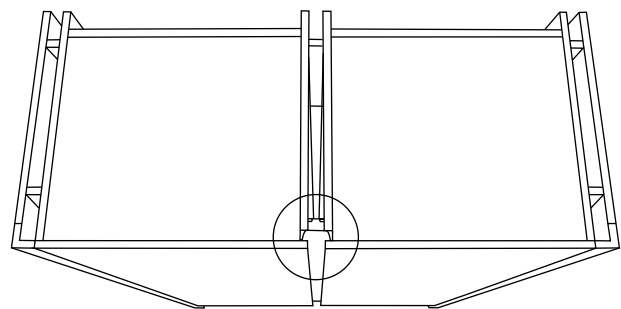

Don't forget to add 35mm spacing in between larder units.

Vertical Profile - Lateral

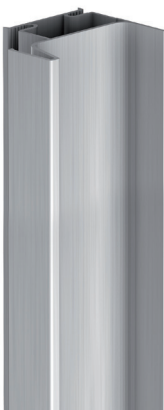
Code XXXVERTEND4200 Finish / Material Aluminium Dimensions 4200 x 53.3 x 41mm Accessories available XXXVERTSPACER	 <ul style="list-style-type: none"> Used on tall units when you have an opening door on one side only, can also be used to end a run where an end post or end panel is fitted. Secured to cabinet gable with 25mm cabinet screws. Can be cut to size using a circular chop saw. A 35mm spacer (not supplied) is required at the back between two cabinets, or between a cabinet and end panel. The front of the cabinet gable needs to be set back by 20mm for the trim to overlap behind the door (unless using TKC's Vero Quickcab). To fix an end post or end panel to the profile you need to drill through the screw support channel and attach the end post from the inside of the cabinet with a 60mm screw.
--	--

DIMENSIONS

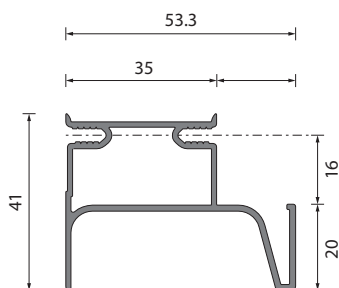

FITTED DETAIL

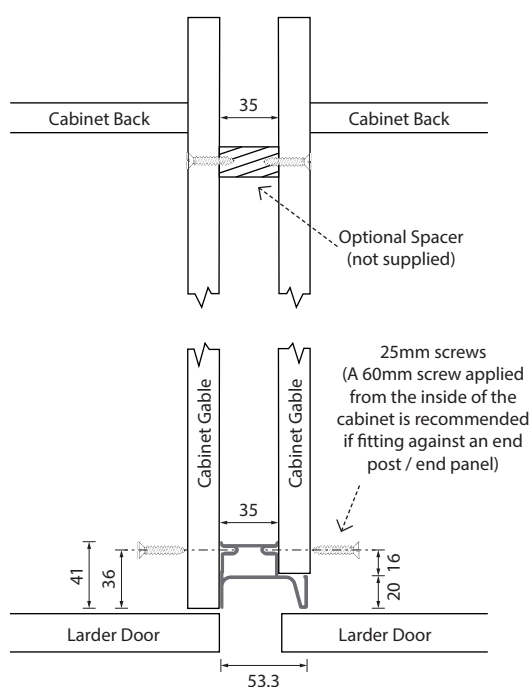

APPLICATION BETWEEN TWO DOORS

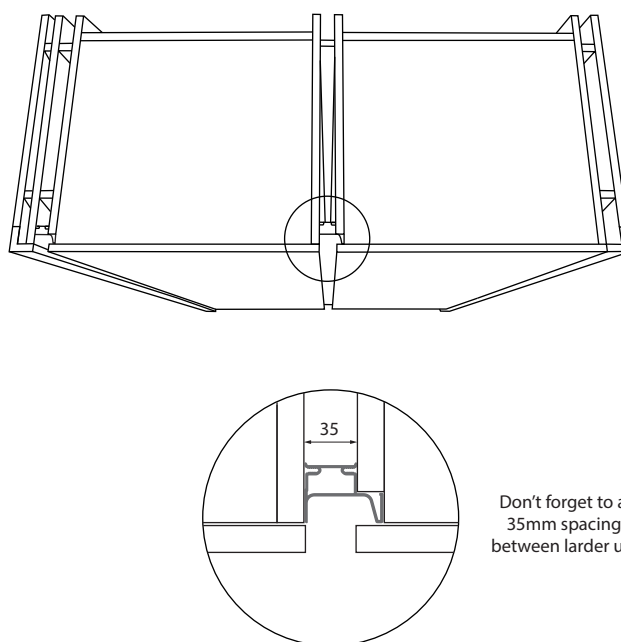

Spacer for Appliance

Code

XXXVERTSPACER

Finish / Material

Aluminium

Dimensions

580 x 19.6 x 20.8mm



- Used to conceal the space behind the front of an appliance when used in an appliance housing unit combined with vertical Vero profiles.
- Fixed into the cabinet gable with 3 screws (4 x 16mm).
- Works with both intermediate and lateral vertical profiles.
- The trim can be cut down to suit different sized appliances. If doing so, we recommend that a metal file is used to remove any sharp edges on the cut edge and that it is positioned out of sight.
- If the appliance requires a screw fixing into the cabinet, the spacer can be drilled into to accommodate the screws.
- **Nb.** When stacking appliances, we recommend leaving a 10mm gap to the top and bottom of both appliances.

DIMENSIONS

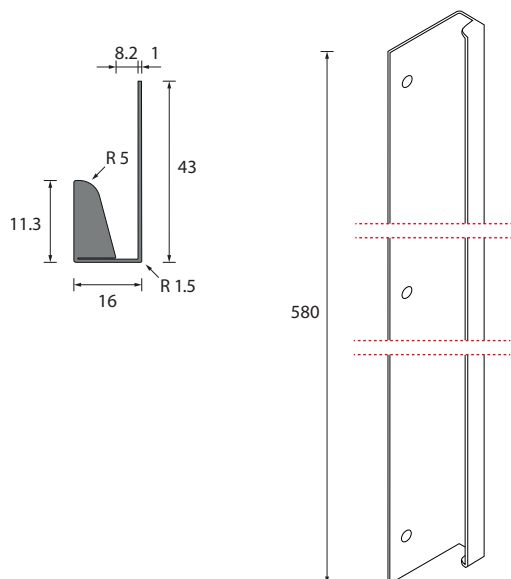

FITTED DETAIL

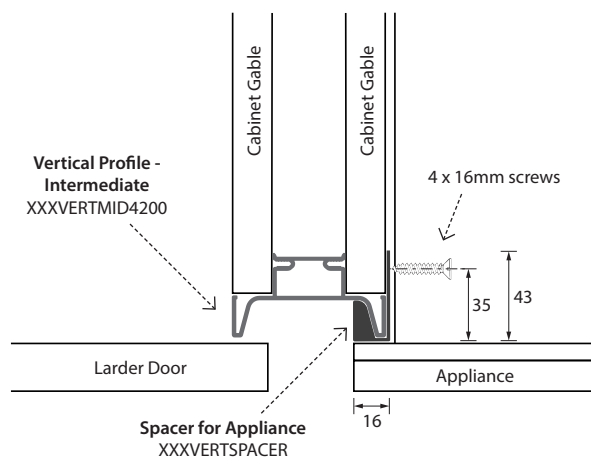

APPLIANCE INSTALLATION

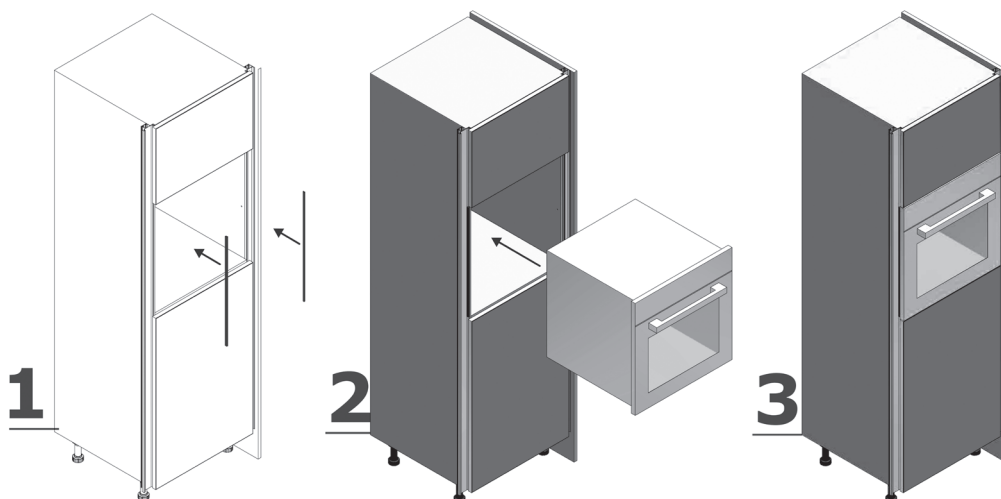

Wall Cabinet Profile

Code

XXXWALL3900

Finish / Material

Aluminium

Dimensions

3900 x 19.6 x 20mm

Accessories available

N/A

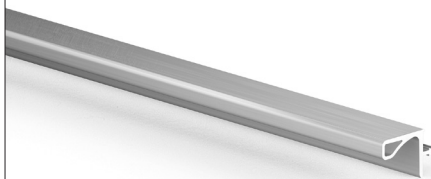

- Concealed rail used on wall units.
- Can be cut to size using a circular chop saw.
- The base panel on the wall cabinet must be set back with 20mm to accommodate the rail profile within the cabinet (unless using TKC's Vero Quickcab).
- The base panel must also have a 8mm deep, 3mm high routed groove for the profile to slot into (pre-routed on TKC's Vero Quickcab).
- Clear silicone adhesive should be used to bind the rail with the panel.

DIMENSIONS

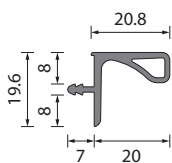

FITTED DETAIL

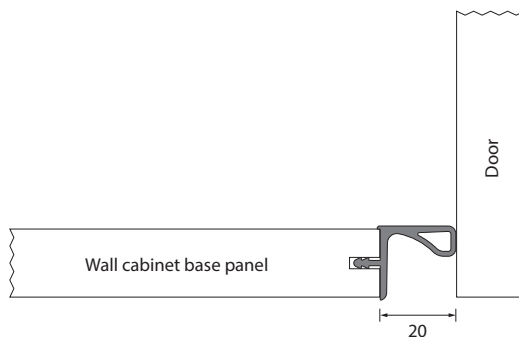

CABINET ROUTING

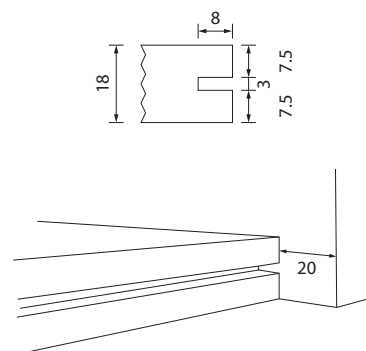

Vero handleless rail system
with Vivo Gloss doors in Stone

Quick Fix Brackets

Code
100QFIX

Finish / Material
Plastic

Dimensions
N/A

Accessories available
N/A

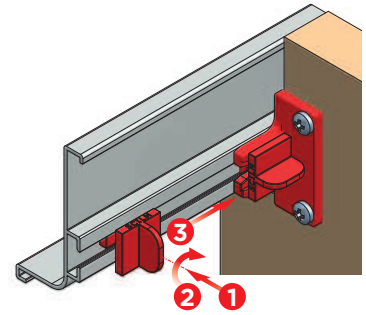
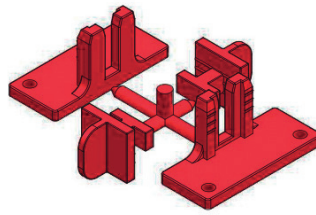

- Screw mounted brackets for top and mid profiles.
- Comes in pairs (min. order 25 pairs).

FITTING TOP AND MID PROFILES

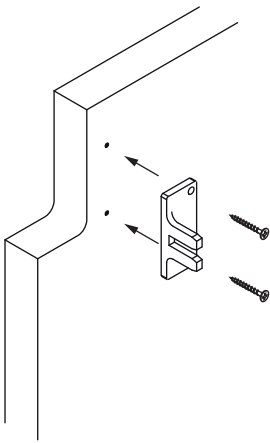

Step 1.
Attach quick fix brackets (100QFIX) to routed cabinet gables using screws.

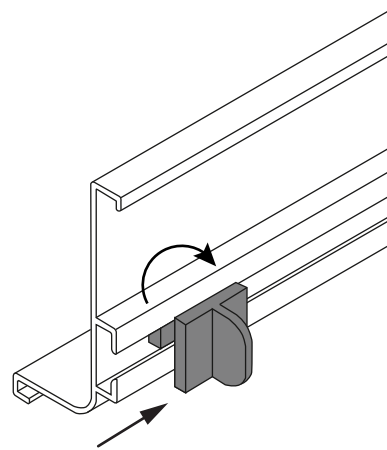

Step 2.
Slide the connectors into the back of the profile and turn 90 degrees.

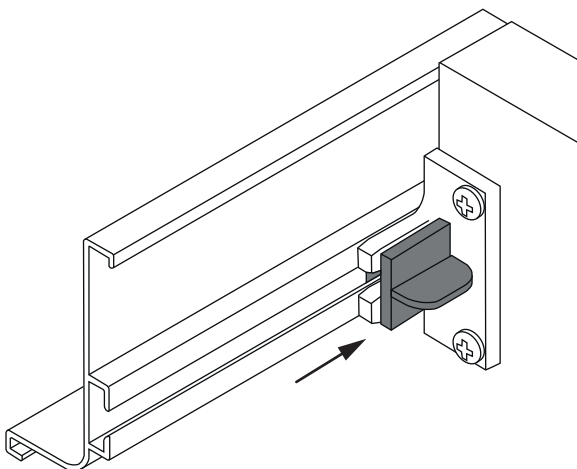

Step 3.
Apply profile to routed cabinet and push connectors into brackets to secure the profile to the cabinet.

See video of how to attach the rails here: www.tkc.co.uk/vero-made-easy

External Corner Joint - Top

Code
XXXTOPEXT90

Finish / Material
Aluminium

- Used to connect two top profiles running around an external corner or an island unit, to be used together with an external corner post.
- Secured to the top profile using two screws (supplied).
- **Nb.** A cut out needs to be made on the routed gable end to accommodate the screw heads behind the external corner joint (see Diagram 1 below).

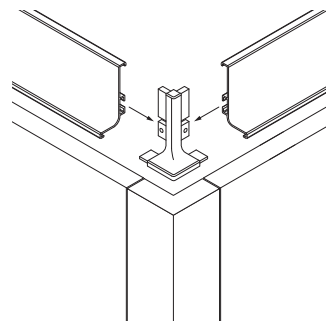
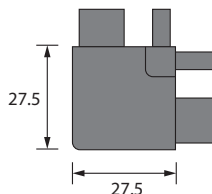
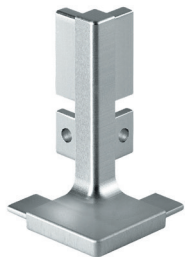

External Corner Joint - Mid

Code
XXXMIDEXT90

Finish / Material
Aluminium

- Used to connect two mid profiles running around an external corner or an island unit, to be used together with external corner posts.
- Secured to the mid profile using two screws (supplied).
- **Nb.** A cut out needs to be made on the routed gable end to accommodate the screw heads behind the external corner joint (see Diagram 1 below).

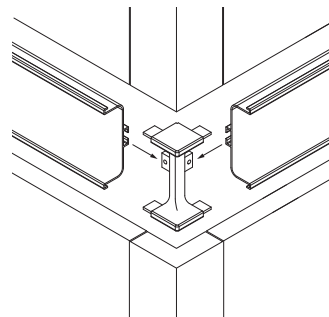
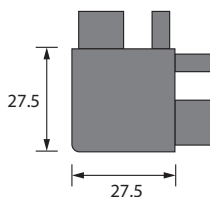
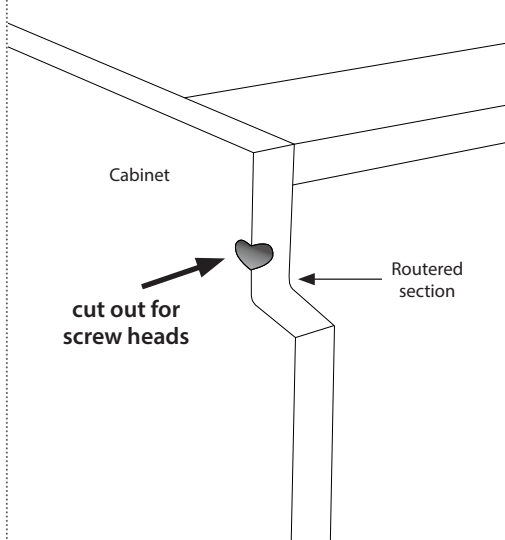

DIAGRAM 1



Before applying the corner joints to the cabinets, a hole needs to be notched out of the routed gable end to accommodate the two screw heads at the back of the corner joints.

Internal Corner Joint - Top

Code
XXXTOPINT90

Finish / Material
Aluminium

- Used to connect two top profiles at an internal corner, to be used together with an internal corner post.
- Secured to the top profile using two screws (supplied).

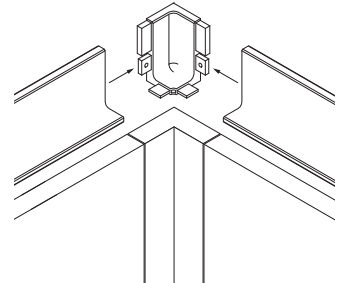
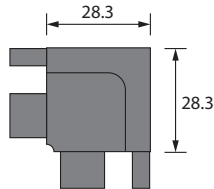
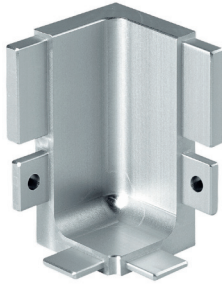

Internal Corner Joint - Mid

Code
XXXMIDINT90

Finish / Material
Aluminium

- Used to connect two mid profiles at an internal corner, to be used together with internal corner posts.
- Secured to the mid profile using two screws (supplied).

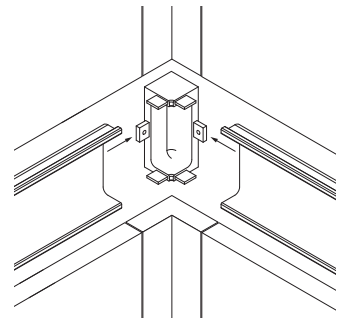
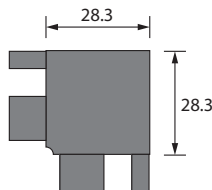
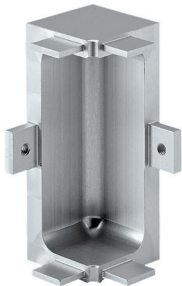

Top Joint

Code
XXXTOPJOINT

Finish / Material
Aluminium

- Used to join together lengths of top profiles.
- Held in place with 4 grub screws (supplied). Grub screw secured with Allen key.
- When using top joints an 8mm spacing must be taken into account when cutting down the profiles that are being joined together.

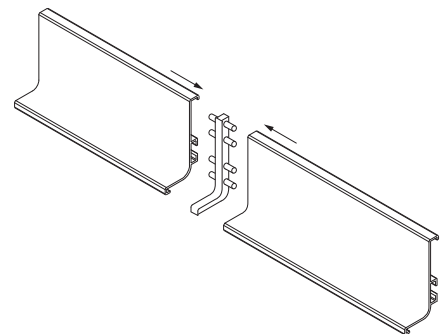
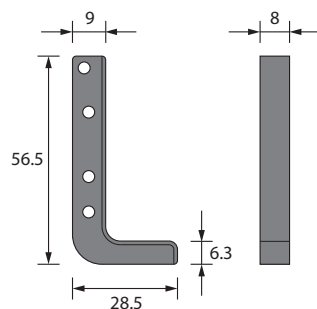

End Caps - Top

Code
XXXTOPENDCAP

Finish / Material
Aluminium

- Used at the end of a top profile for example against a wall, end panel or next to appliances such as under mounted oven.
- Secured to the top profile using a grub screw (supplied). Grub screw secured with Allen key.
- When using end caps, a 2mm spacing must be taken into account when cutting down the trim.

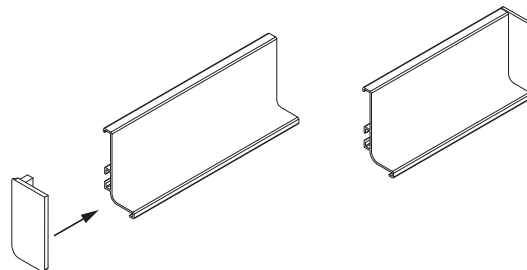
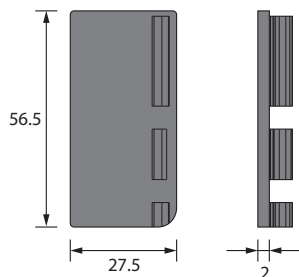
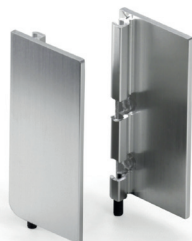

End Caps - Mid

Code
XXXMIDENDCAP

Finish / Material
Aluminium

- Used at the end of a mid profile for example against a wall, end panel or next to appliances such as an under mounted oven.
- Secured to the mid profile using a grub screw (supplied). Grub screw secured with Allen key.
- When using end caps, a 2mm spacing must be taken into account when cutting down the trim.

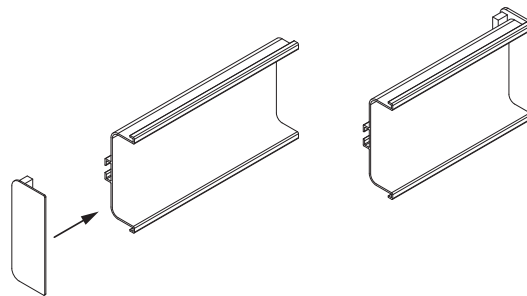
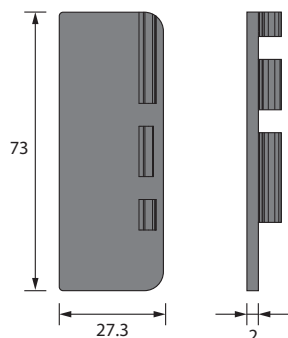

Suggested door & drawer combinations for the Vero handleless rail system

Medium height (1970mm) & tall height (2150mm) installation. Base unit door sizes are designed specifically to suit Vero profiles. All wall unit doors are standard TKC door sizes.

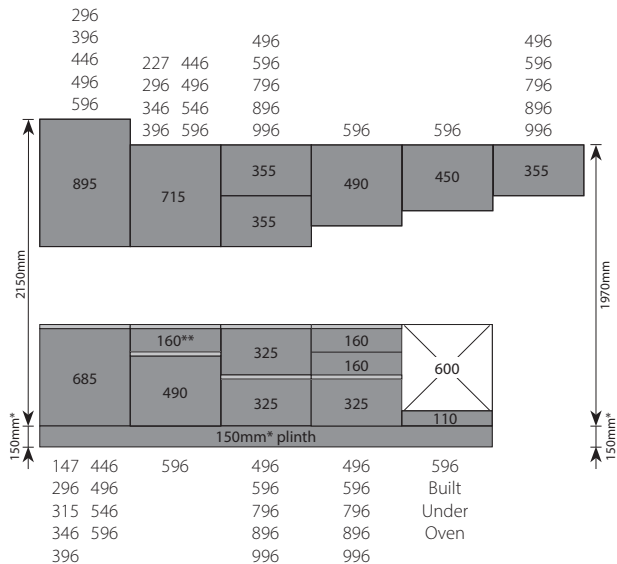

Medium height installation (1970mm). All full length & appliance unit doors are standard TKC door sizes.

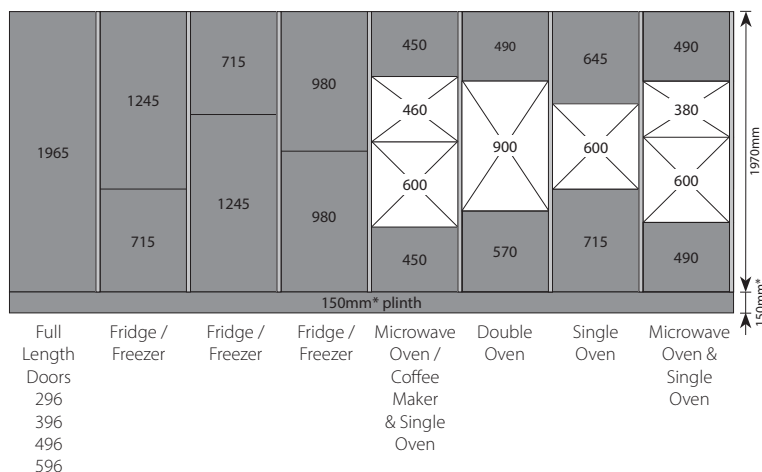

Studio height installation (1250mm). Doors using vertical profiles are standard TKC door sizes. Doors using horizontal profiles are specifically designed to suit Vero.

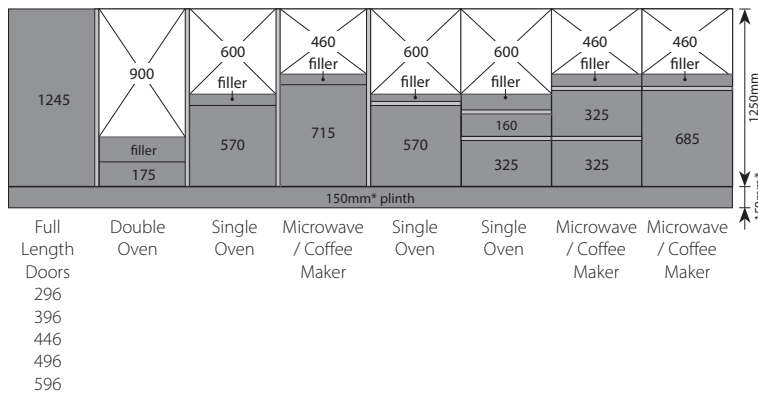

Tall height installation (2150mm). All full length & appliance unit doors are standard TKC door sizes.

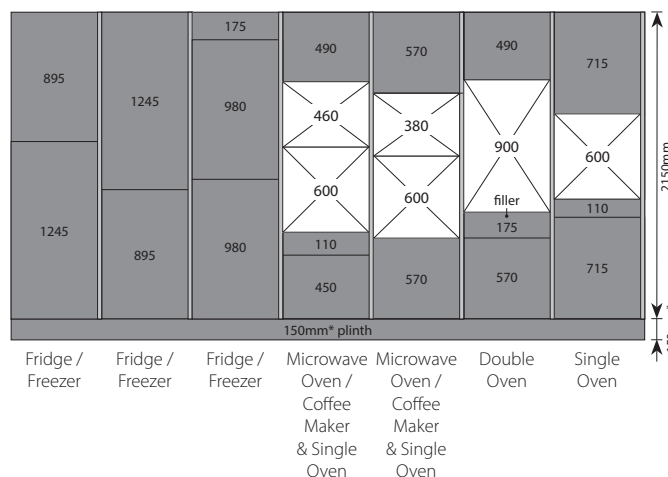

* Plinth height may vary. If integrated under counter appliances are installed, please raise cabinet legs to ensure appliance fits easily underneath the top rail. See p. 10 for more info.
** TKC don't supply Vero Quickcab carcasses for this door combination.